



BEST
Easels by Richeson

HOW TO ASSEMBLE THE Student Chimayo Easel

#882300

BEST ARTIST'S MATERIALS - A RICHESON COMPANY - KIMBERLY, WI - PHONE: 1.800.233.2404 - RICHESONART.COM

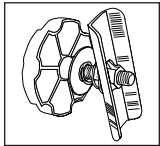

WEDGE-LOK SYSTEM

Height and tray adjustments unlock easily, yet lock into place and stay

locked because of the Wedge-lok System. The metal plate features wedge-cut edges that conform to the wedge-cut sections of the hardwood. When the knob is tightened, the inward tension pulls the metal plate snugly against the wood for a solid lock.

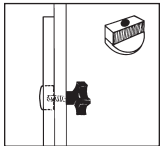

SLIDE GUIDES

Slide Guides make angle and height adjustments on BEST easels

smooth. These circular graphite impregnated plastic inserts are used wherever there is a slot in the wood of the easel. This part allows for smooth movement and protects the hardwood from the metal bolt.

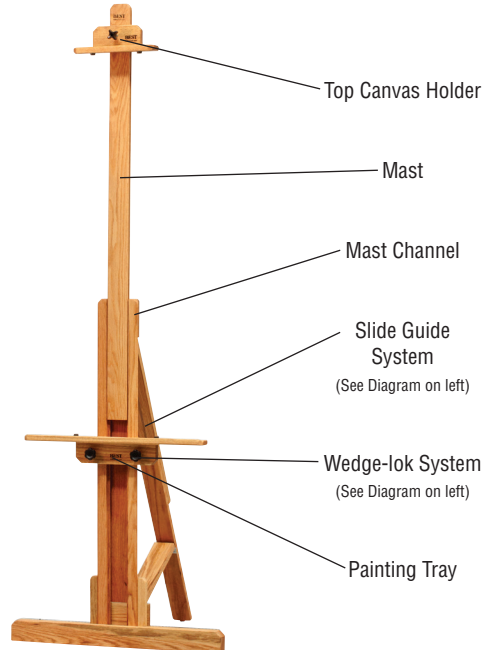

EASEL ASSEMBLY

1. Take Easel out of box.
2. Loosen Slide Guide System on back leg, open Easel up and tighten knob at the desired angle.
3. Loosen the knob on the back of the easel to adjust the Mast.
4. Loosen the Wedge-lok knobs on Painting Tray, slide down the Mast Channel and tighten knobs at desired height.
5. Loosen black knob on Top Canvas Holder, slide onto Mast and tighten knob at desired height.