

HOW TO ASSEMBLE Portable Collapsible BEST Easel #887110

BEST Artist's Materials - A Richeson Co. - Kimberly, WI - Phone: 1-800-233-2404 - www.richesonart.com 6/16

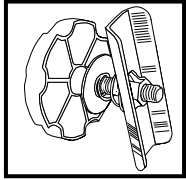

Height & tray adjustments unlock easily, yet lock into place & stay locked because of the **Wedge-lok System**. The

metal plate features wedge-cut edges that conform to the wedge-cut sections of the hardwood. When the knob is tightened, the inward tension pulls the metal plate snugly against the wood for a solid lock.

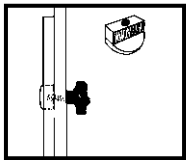

Slide Guides make angle and height adjustments on BEST easels smooth. These circular

graphite impregnated plastic inserts are used wherever there is a slot in the wood of the easel. This part allows for smooth movement and protects the hardwood from the metal bolt.

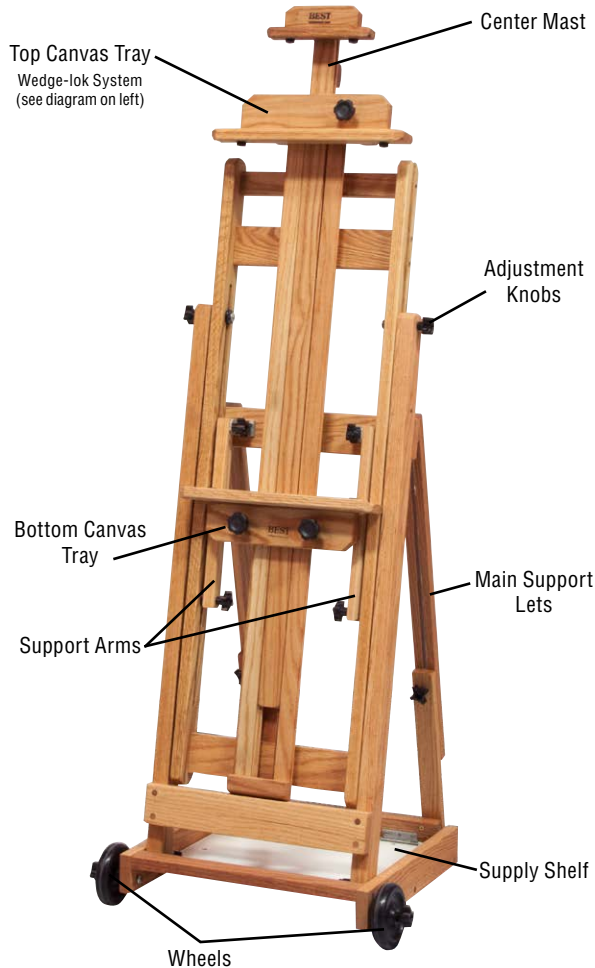

- **Elegant single mast design**
- **Hand-rubbed, oil finished solid oak**
- **Modest price range**
- **Ships partially assembled**
- **Holds canvases up to 60" tall**
- **Folds flat for easy storage and mobility**
- **Adjusts easily to a variety of positions**

- **Width: 21" (with wheel base)**
- **Depth: 18"**
- **Extended Height: 73¾"**
- **Collapsed Height: 40¼"**
- **Painting Tray Width: 13"**
- **Recommended Max. Painting Ht: 60"**



Easel Assembly

- 1.) Loosen all black plastic knobs before trying to set up. Set easel on base. Open up, tighten knobs and use the **Slide Guide System** to get easel to the desired angle.
- 2.) Slide mast out and turn it around. Slide mast back in with the top canvas support facing front.
- 3.) Loosen **Wedge-lok System** on canvas holders and slide down the center mast. Slide to desired position and tighten.

Wheel Assembly

- 1.) Push bolt (1) through pre-drilled hole; head of bolt to the inside of easel.
- 2.) Slip circular washer (2) onto bolt (1).
- 3.) Put nut (3) on next and tighten.
- 4.) Slip on the wheel (4).
- 5.) Slip on second circular washer (5).
- 6.) Put on four pronged knob (6) and tighten.
- 7.) Repeat steps 1-6 on other side.