

The Elevator Bolt Locking System is used on top trays on Best easels. The 2 metal plates and round plastic guide keep the parts parallel which allows for smoothness and ease when the tray is moved

into position. By tightening the knob, the circular plate will seal itself against the mast. This means ultimate stability for the canvas.

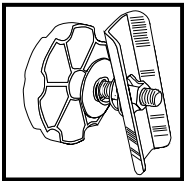

Height & tray adjustments unlock easily, yet lock into place & stay locked because of the Wedge-lok System. The metal plate features wedge-cut edges that conform to the wedge-cut sections of the hardwood. When the knob

is tightened, the inward tension pulls the metal plate snugly against the wood for a solid lock.

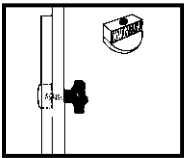

Slide Guides make angle and height adjustments on Best easels smooth. These circular graphite impregnated plastic inserts are used wherever there is a slot in the wood of the easel. This part allows for

smooth movement and protects the hardwood from the metal bolt.

Easel Assembly - Rio Grande

- 1.) Open box & lift easel out. For your convenience, the easel is pre-assembled into two sections.
- 2.) The H-frame with the mast must be lifted out and turned over. Line up the pre-drilled holes with the lower section (H-Frame Support) of the easel. Insert all four 2¹/₄" bolts and secure with the small black knobs.
- 3.) To lower the back legs, loosen black knobs and fold the back legs down. Tighten the knobs in the desired position.
- 4.) The top and bottom painting trays are turned for protection during shipping. Loosen the black knobs and slide out of mast to turn them around so the tray is facing forward.
- 5.) The middle canvas tray can be attached and removed as needed.
- 6.) Your Rio Grande Easel should look like the image above when finished.

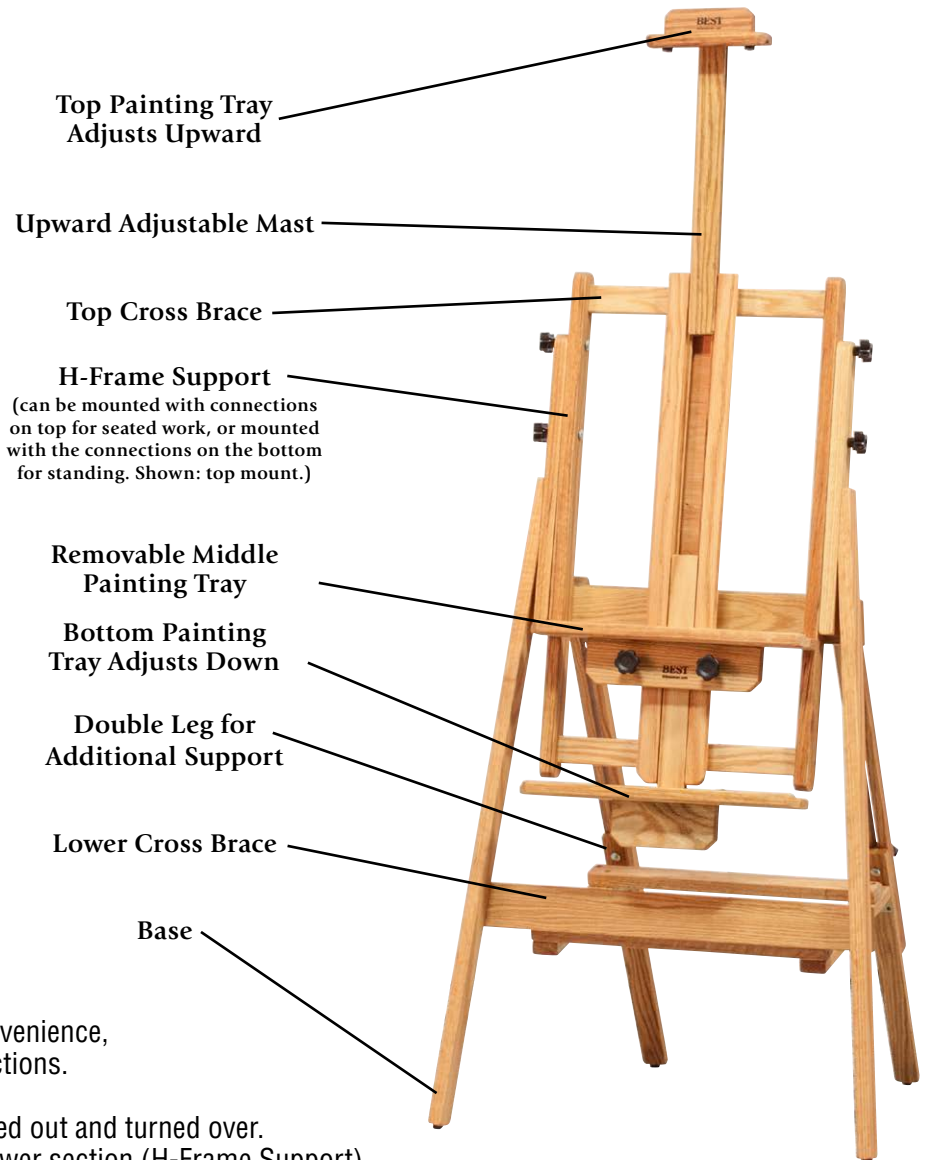

Alternative H-Frame Setup

The Middle Painting Tray can be flipped 180° to support a larger painting while the artist is working from a seated position.