

HOW TO ASSEMBLE THE Abiquiu w/tray #880150 & Abiquiu Deluxe w/tray #880176

BEST Artist's Materials - A Richeson Co. - Kimberly, WI - Phone: 1-800-233-2404 - www.richesonart.com 3/16

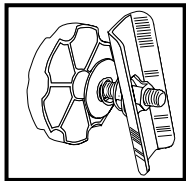

Height & tray adjustments unlock easily, yet lock into place & stay locked because of the **Wedge-lok System**. The metal plate features wedge-cut

edges that conform to the wedge-cut sections of the hardwood. When the knob is tightened, the inward tension pulls the metal plate snugly against the wood for a solid lock.

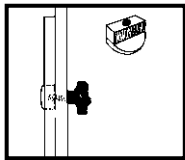

Slide Guides make angle and height adjustments on Best easels smooth. These circular graphite impregnated plastic inserts are used

wherever there is a slot in the wood of the easel. This part allows for smooth movement and protects the hardwood from the metal bolt.

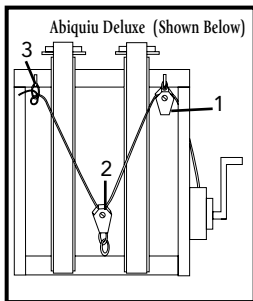

Pulley System
Insert rope through **Pulley 1**, then through **Pulley 2**. Pull rope up. Thread rope through **Hook**

Screw (3) on left. Wrap back around rope itself several times then knot securely.

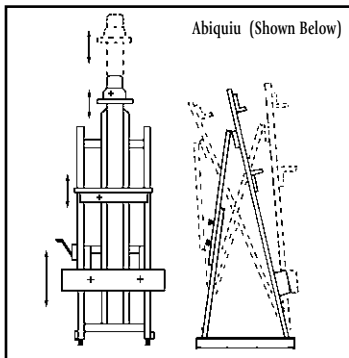

Achieve these angles with either the Abiquiu or Abiquiu Deluxe by using the **Slide Guide System**.

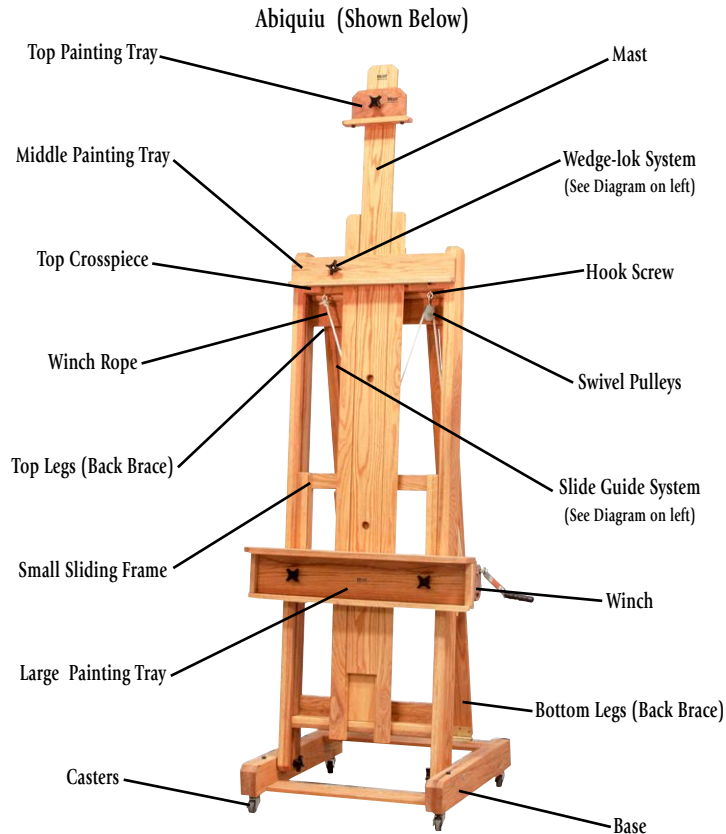

- **Laminated 2' x 5' oak uprights for ultimate strength**
- **Double laminated base for added stability**
- **Hand-rubbed, oil-finished solid oak for beauty & longevity**
- **Front locking, heavy duty casters make moving & locking into place effortless**
- **36" wide bottom painting tray features tool shelf for convenient holding of brushes, paint, solvent & other painting supplies**
- **A variety of tilt & height settings to meet all painting needs**

Easel Assembly - Abiquiu, Abiquiu With Tab Tray, Abiquiu Deluxe

- 1.) Set easel on base. Lay down legs to the back of the easel. Place frame face down on floor. Attach to base by lining up pre-drilled hole. The $\frac{5}{16}$ " x 5" bolt goes from the outside to the inside.
- 2.) Put Mast(s) in. Be careful to hold mast(s) straight while guiding into the frame.
- 3.) Leave frame upright, connect bottom legs (inside) to the top legs (outside). The $\frac{1}{4}$ " x $2\frac{1}{4}$ " bolts go from the inside to the outside - attach **Slide Guide Systems** and knobs - adjust to desired angle and tighten.
- 4.) Attach Winch to easel. Start the 5 wood screws on Winch, position over pre-drilled holes on base of easel and secure to easel by tightening screws.
- 5.) To put handle on, take large bolt off, put handle on and tighten bolt.
- 6.) Large paint tray - loosen **large knobs**. Attach to small inside frame of easel. Tighten knobs. To use the Tab tray, turn Large paint tray upside down and reattach to small inside frame. Attach Tab tray to small inside frame; adjust so it rests on top of the Large paint tray. The Large paint tray will then act as a support for the Tab tray. Loosen the **Wedge-lok System** to adjust the Middle paint tray. Loosen knob(s) on Small paint tray(s) to adjust height. The Middle tray can be used as top or bottom tray for smaller paintings.
- 7.) To install **Pulley System**, please see diagram at left. Same procedure for Abiquiu & Abiquiu Deluxe.